

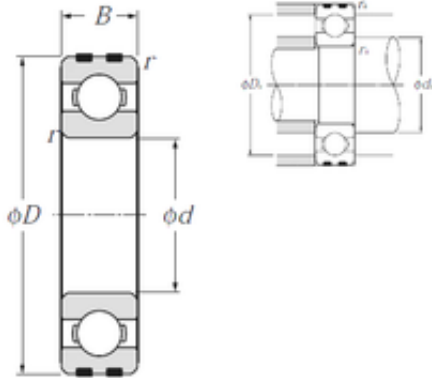

# INA Rolamentos do Brasil Ltda.

## 10 mm x 30 mm x 9 mm NTN EC-6200 Rolamentos de esferas profundas

Bearing No. EC-6200



EC-6200 Bearing 2D drawings and 3D CAD models

Size	10x30x9 mm
Bore Diameter	10 mm
Outer Diameter	30 mm
Width	9 mm
d	10 mm
D	30 mm
B	9 mm
C	9 mm
r min.	0,6 mm
da min.	14 mm
da max	16 mm
Da max.	26 mm
ra max.	0,6 mm
Weight	0,031 Kg
Basic dynamic load rating (C)	5,1 kN
Basic static load rating (C0)	2,39 kN
(Grease) Lubrication Speed	25 000 r/min
(Oil) Lubrication Speed	30 000 r/min